

22ND ST.



5



3



8

- 1 Preserved Trees
- 2 Preserved Specimen Paper Bark Tree
- 3 36x18x18 Gabion basket retaining wall
- 4 36x18x18 Gabion basket seat wall w/ 4' Long CIP Concrete Seats
- 5 SoMA Stone Seating, 5 Existing
- 6 DG gravel
- 7 Succulent Groundcover
- 8 Creeping Thyme Groundcover
- 9 Pollinator Garden
- 10 Galvanized steel edging
- 11 Carex Grass
- 12 Recycled Concrete Stepping Slabs
- 13 Park Sign

NORTHBOUND CAROLINA ST.

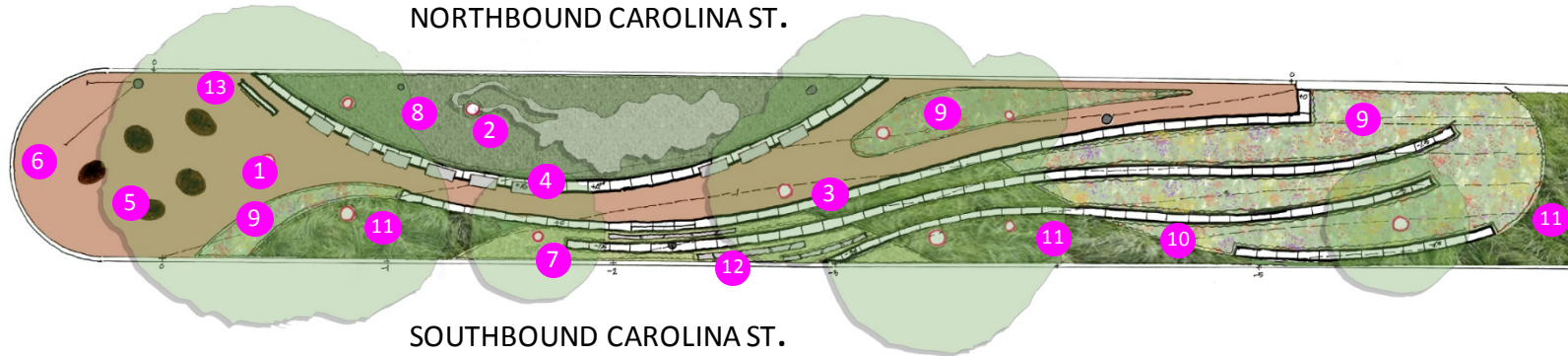

SOUTHBOUND CAROLINA ST.



6



7